

技術及び力の完全な合併

チェーンブロック 指示 手動  
**CHAIN BLOCK INSTRUCTION MANUAL**



The Complete Amalgamation  
of Technology and Power



Before proceeding with the operation or maintenance of the equipment it is important that the operating, and maintenance personnel read this bulletin carefully in order to ensure the safe and efficient use of the equipment.

Also, it is strongly recommended that the personnel responsible for the operation, inspection, and servicing of this hoist, read and follow the safety standard or current revised edition. Proper use is important to the ultimate performance of this equipment. Careful study of and adherence to the instructions will help ensure safe, dependable operation. It is also recommended that you keep this manual readily accessible to operators as well as maintenance and safety personnel.

If any instructions are unclear, contact the manufacturer or distributor of the equipment before attempting to install or use the hoist.

<b>1 General</b> . . . . .	4
1.1 Installation	
1.2 Operating Procedures	
1.3 Operating Practices	
<b>2 Packaging</b> . . . . .	4
<b>3 Safety Instructions</b> . . . . .	5
3.1 <b>DOS:</b>	
General	
Transport / Storage	
<b>4 Preventative Maintenance</b> . . . . .	5
4.1 Maintenance Schedule	
<b>5 DON'TS</b> . . . . .	6
<b>6 Spare Parts</b> . . . . .	7

*Information in this manual is subject to change without notice.*

## 1 General

Check that the equipment furnished corresponds with the details on the packing slip attached to the packaging. Limit loads to half of the nominal load capacity during periods of extreme cold weather where the ambient temperature is less than -15 °C.

### 1.1 Installation

Make sure the supporting structure is designed to withstand the loads and forces imposed by the hoist/trolley. Also, make sure trolley stops are installed at the limits of trolley travel. Trolley stops shall not be used as a continuing means of stopping the trolley, if a trolley is used.

### 1.2 Operating Procedures

The hoist lifts and lowers the rated load in a controlled manner when a manual force is applied to the hand chain. The hoist is equipped with a brake, which sustains and controls the rated load when the hoist is being operated in either direction.

The manual chain hoists are for lifting and lowering. The use of the hoists for pulling or side pulling is not allowed because the chain guides and positioning of other parts are not designed for this type of operation.

### 1.3 Operating Practices

In addition to the Safe Instructions – Dos and Don'ts, it is recommended that the following operating practices be adhered to when using a manual chain hoist.

The operator shall familiarize himself with the operation of the equipment and its proper care. If adjustments are necessary or damage is known, the unit must be removed from service and not used until corrections are made.

## 2 Packaging

The various models are delivered assembled and packed in cardboard boxes.

## 3 Safety Instructions

### 3.1 DOS:

#### *General*

Read the manual carefully and always follow the recommendations, instructions, warning information, and make all people who will operate the equipment aware of these. Only use "original parts" when repairing or maintaining. Keep the manual near the equipment and readily available to the operator and the maintenance and safety personnel at all times.

#### *Transport / Storage*

Handle the equipment by its structure either using the fittings provided for this purpose or in its original packaging. Store the equipment in a non-aggressive environment away from sources of dust or dampness etc. Regularly clean and protect from corrosion (oil, etc.).

## 4 Preventative Maintenance

### 4.1 Maintenance Schedule

The maintenance and inspection intervals are based on normal duty under normal environmental conditions (free from excessive dust, moisture, and corrosive fumes). If duty is heavier or environment more severe, maintenance and inspection intervals should be shortened and more frequent.





**DO NOT** overload your chain block



**DO NOT** allow anyone to stand or pass beneath the raised load

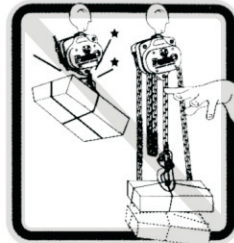

**DO NOT** pull up too far or pull down slamming fast

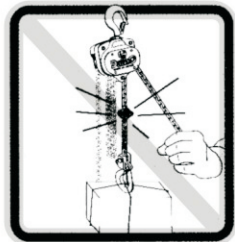

**DO NOT** attempt to lift a load if the load chain is kinked or knotted



**DO NOT** use the chain block to drag the load across the floor

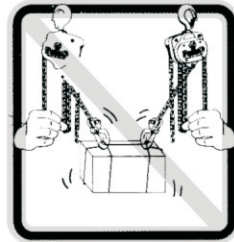

**DO NOT** try to raise a load with two, or more, chain blocks

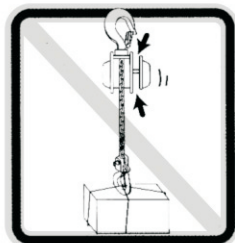

**DO NOT** fail to make sure that the holder pawl perfectly holds the holder plate

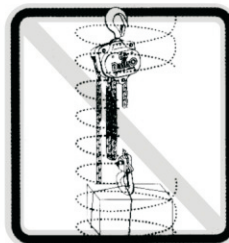

**DO NOT** rotate the chain block when holding loaded

5 Spare Parts

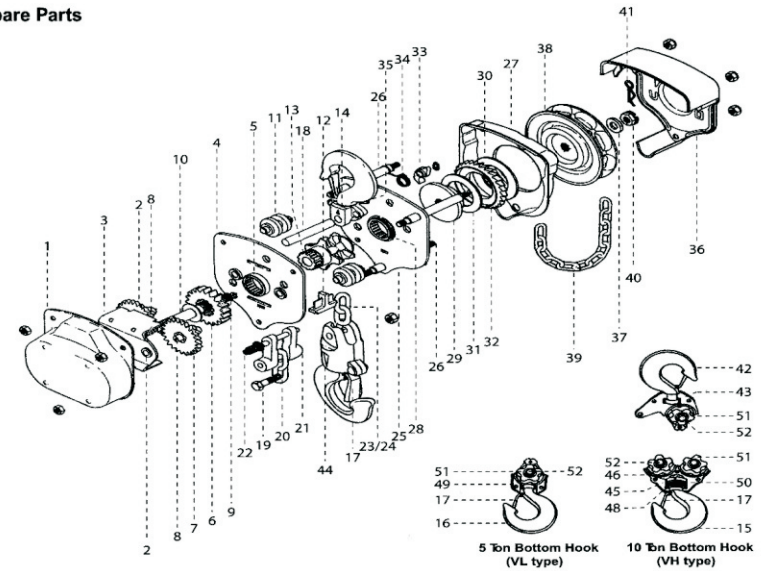

No.	Description	Quantity	No.	Description	Quantity
1	Gear Cover	1	27	Brake Cover	1
2	Gear Bushing	4	28	Needle Bearing	1
3	Support Plate	1	29	Hub	1
4	Side Plate (II)	1	30	Brake Disc A	1
5	Needle Bearing	1	31	Brake Disc B	1
6	1st Gear	1	32	Ratchet Gear	1
7	2nd Gear	2	33	Pawl	1
8	3rd Gear	2	34	Spring	1
9	Pinion Shaft	1	35	Pawl Stud	1
10	Pinion Washer	1	36	Wheel Cover	1
11	Load Chain Guide	2	37	Hand Wheel Washer	1
12	Chain Stripper	1	38	Hand Wheel	1
13	Load Sheave	1	39	Hand Chain	1
14	Top Hook	1	40	Pinion Nut	1
15	Bottom Hook (VH)	1	41	Cotter Pin	1
16	Bottom Hook (VL)	1	42	Top Hook	1
17	Safety Latch	1	43	Top Frame	2
18	Hook Pin	1	44	Bottom Hook	1
19	Bolt & Nut for Load Chain	1	45	Thrust Bearing	1
20	End Pin	1	46	C-Link	2
21	End Anchor	2	47	O-Link	1
22	End Spring	1	48	Thrust Washer	1
23	Load Chain (VL)	1	49	Bottom Frame	2
24	Load Chain (VH)	1	50	Bottom Frame	2
25	Side Plate (I)	1	51	Sheave	
26	Stay Bolt	3	52	Axle	

Items without part numbers are non-stocked replacement parts.